

THE

# ROSSANO

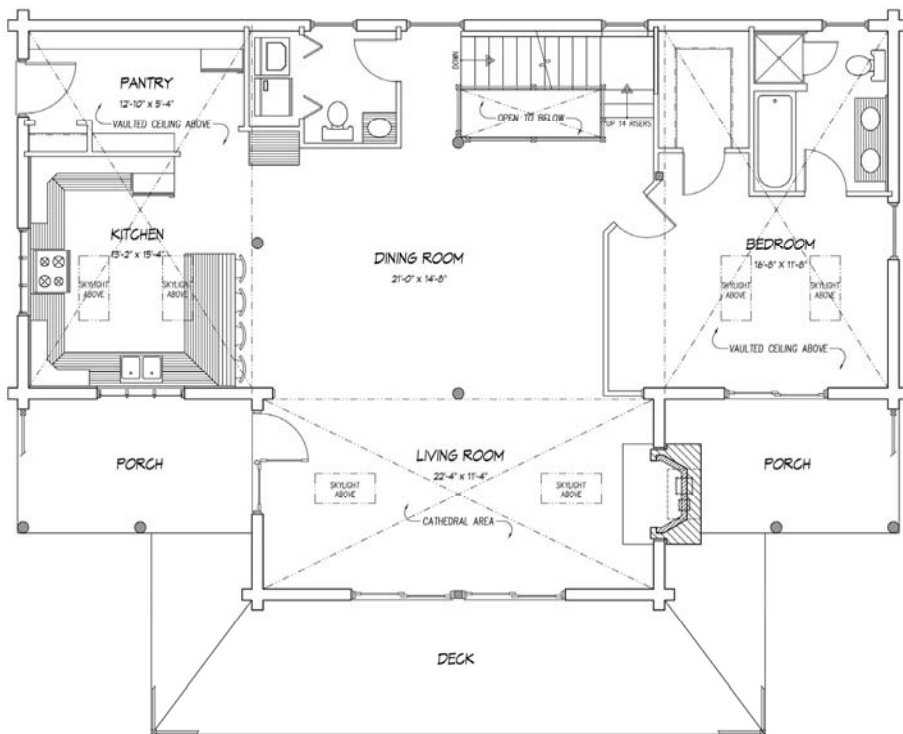

### FIRST FLOOR PLAN

\* Daylight basement also includes (2) bedrooms and family room.

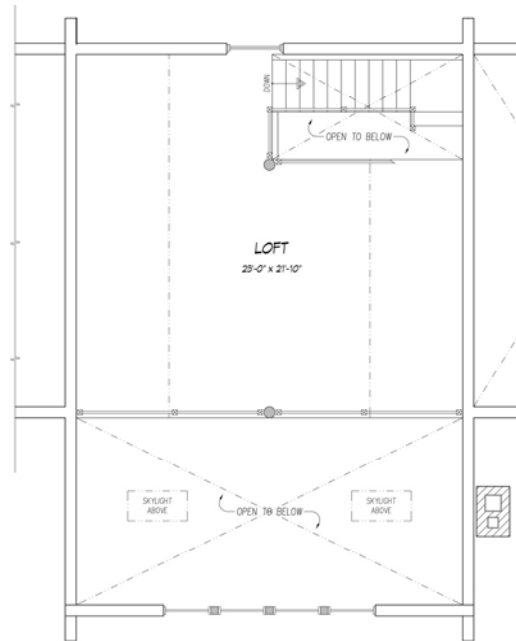

### SECOND FLOOR PLAN

#### PLAN SPECIFICATIONS:

LIVING AREA:	1894 S.F.
SIZE:	22' x 52' w/ 12x24' EXTENSION
BEDROOMS:	3
BATHROOMS:	2.5

Elk Country Construction, LLC  
 2900 N Govt Way, Box 75  
 Coeur D Alene, ID 83815  
 (208) 660-0659  
 www.ElkCountryConstruction.com

THE

# ROSSANO



## PRICING

- **CONTOURS, V-GROOVES OR CLAPBOARDS .....\$81, 820**

*\*Price does not include materials for the daylight basement. Actual log package price will depend on options selected.  
Price subject to change without notice. Contact your Independent Representative for details.*

## STANDARD PACKAGE COMPONENTS

- PRE-CUT SOLID LOG WALLS AND GABLE ENDS (PER PLAN) FEATURING OUR PATENTED INTER-LOCK™ LOG JOINERY SYSTEM INCLUDING:
  - OLYMPIC LOGHOG® FASTENERS, PVC LOCKSPLINE™, NORTON LOG HOME FOAM™, SASHCO® LOG BUILDER CAULK, FOAM BLOCKS AND PRE INSTALLED CORRUGATED FASTENERS, SPECIAL MILLED FRAMESTOCK
- ANDERSEN® 400 SERIES WINDOWS AND PATIO DOORS WITH:
  - TERRATONE EXTERIOR, HIGH PERFORMANCE (LOW-E) GLASS, TERRATONE SCREENS, STONE HARDWARE, AND NATURAL CLEAR PINE INTERIOR
- THERMA-TRU® FIBER-CLASSIC DOORS
- LOG SIDING SKIRTBOARD
- LOG SIDING AT EXTERIOR WALLS (PER PLAN)
- PRE-CUT LOG JOISTS INCLUDING PRE-NOTCHING LOG WALL (PER PLAN)
- PRE-CUT AND NOTCHED HEAVY TIMBER GIRDERS (PER PLAN)
- PRE-CUT LOG RAFTERS (PER PLAN)
- GLU-LAMINATED RIDGE BEAMS (PER PLAN)
- LOG/SQUARE SUPPORT POSTS & SETTLING SCREWJACKS AS REQUIRED
- PORCHES:
  - LOG POSTS, PRE-CUT LOG PLATES, & PRE-CUT LOG RAFTERS
- TIM-BOR®, AN EPA-REGISTERED WOOD PRESERVATIVE
- 3 SETS OF BLUEPRINTS WITH ASSEMBLY DETAILS
- PRE-CUT LOG WALL ASSEMBLY INSTRUCTIONS
- COMPLETE LIST OF MATERIALS INCLUDED IN THE PACKAGE
- FULLY ILLUSTRATED CONSTRUCTION MANUAL
- FOUR HOURS OF COMPLIMENTARY TECHNICAL ASSISTANCE

THE STANDARD PACKAGE COMPONENTS WILL VARY DEPENDING ON THE FEATURES OF A PARTICULAR HOME.



CONTACT YOUR INDEPENDENT REPRESENTATIVE FOR MORE DETAILS AND OUR EXTENSIVE LIST OF OPTIONS.